

# WYNDHAM COLLECTION

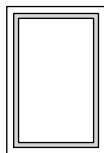

- Prior to installation please check received items against the "Packing List". Please report any missing items to your retailer immediately.
- Protect all surfaces from sharp objects, high heat sources, direct prolonged sunlight and chemical hazards.
- Professional installation recommended.

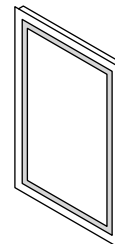

## BEFORE YOU BEGIN INSTALLATION

Please review the instructions below carefully before starting the installation process. Keep this guide in a safe place for future reference.

- Hire a licensed electrician for all electrical wiring and installation procedures.
- Disconnect all power at the main circuit breaker before installation.
- Inspect the package contents prior to installation and before discarding any packaging.
- This mirror must be hardwired to a dimmable wall switch to use the built-in dimming feature.
- The mechanical switch located on the bottom of the mirror must remain ON when using the wall switch to operate the mirror.
- Note: The defogging feature will automatically disable when the mirror is dimmed.

## IMPORTANT SAFETY INSTRUCTIONS

To reduce the risk of electric shock, injury, or fire, please follow these safety guidelines:

**DANGER** - Electrical safety:

- Disconnect power at the circuit breaker before servicing the mirror.
- Do not allow children, elderly individuals, or those with limited mobility to use the mirror without supervision.
- Use this product only as described in this guide.
- Do not use the mirror if the wiring appears damaged, the product malfunctions during testing, or if it has been dropped or exposed to moisture.
- Keep all cords away from hot surfaces and avoid placing the mirror near heat sources.
- Never insert foreign objects into any openings in the electrical components.
- This mirror is intended for indoor use only.
- To fully disconnect the unit, turn off the wall switch and cut power at the breaker.

**⚠ WARNING: Risk of Electric Shock - This product must be connected to a properly grounded outlet.**

WC-LEDWSDSL2436  
Installation Guide

# WYNDHAM COLLECTION

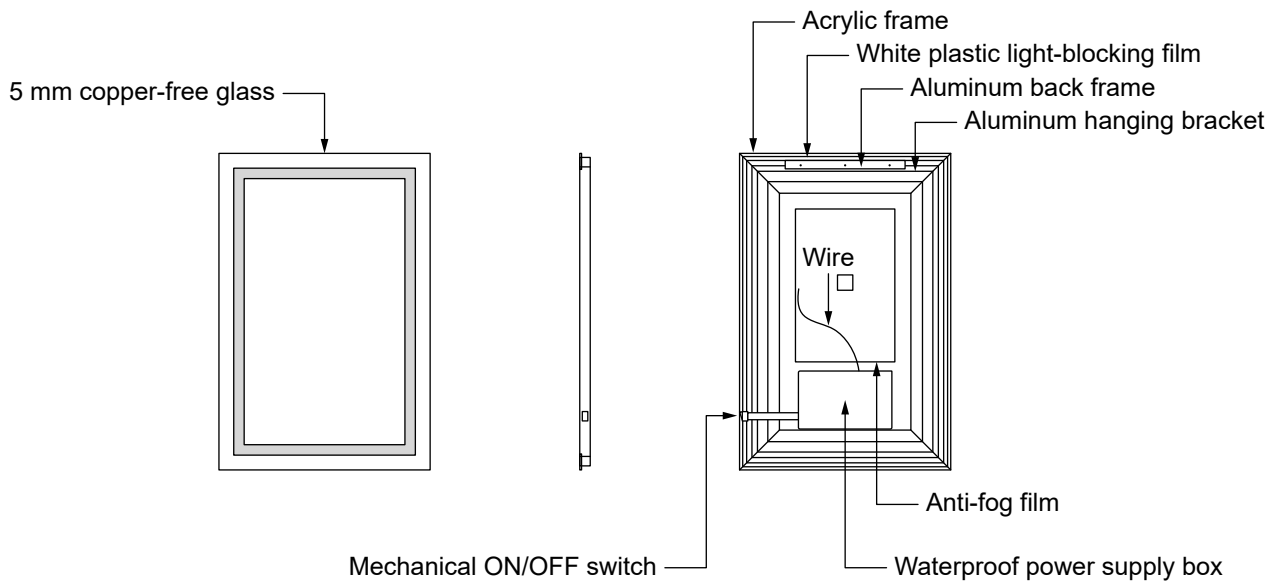

## PACKING LIST

(Not all components may be included, depending on your purchase)

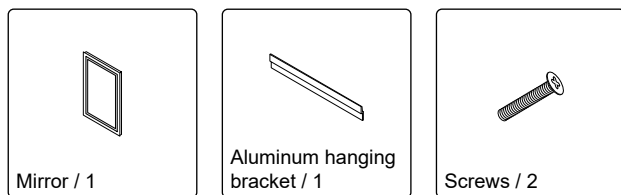

## REQUIRED TOOLS NOT IN BOX

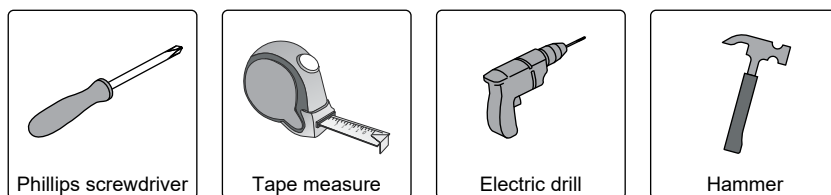

WC-LEDWSDSL2436  
Installation Guide

# WYNDHAM COLLECTION

## INSTALLATION INSTRUCTIONS

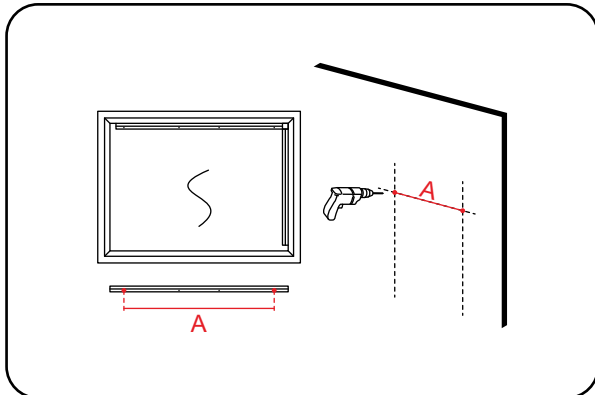

### ① Select Mounting Location

Choose a suitable location for the mirror, ensuring the main electrical supply is accessible and within reach of the mirror's electrical entry point.

The mounting bracket must be secured to a wall stud for proper support.

Measure distance "A" (as indicated in the diagram), and mark the positions for drilling.

Drill holes at the marked points using an appropriate tool.

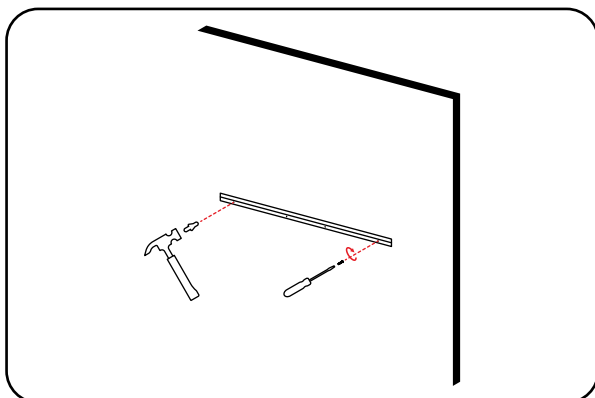

### ② Step 2: Install Wall Plugs & Mounting Bracket

Insert the supplied wall plugs into the drilled holes.

Fasten the mounting bracket securely to the wall using the provided screws.

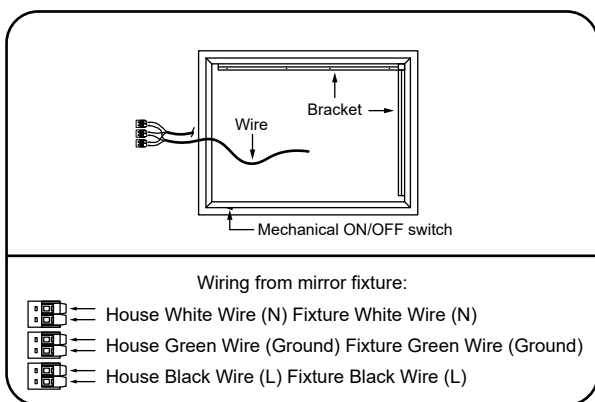

### ③ Step 3: Electrical Wiring

**⚠ Important: Ensure power is turned off at the circuit breaker before beginning any electrical work.**

A junction box must be present inside the wall at the connection point.

Connect the mirror's fixture wires to the house wiring as indicated in the diagram.

Input Voltage: 110V

## WC-LEDWSDSL2436 Installation Guide

# WYNDHAM COLLECTION

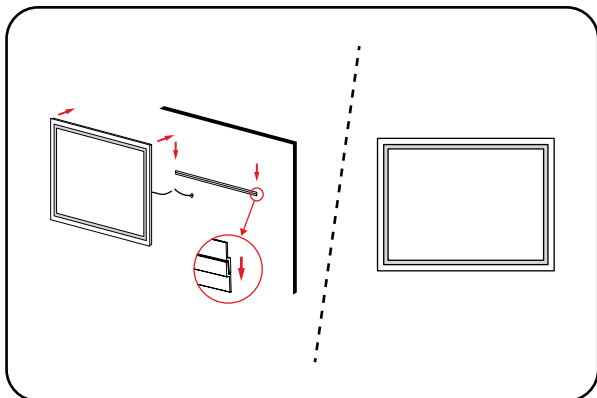

#### ④ Step 4: Final Assembly

Carefully hang the mirror on the mounted bracket.

Peel off the protective film from the mirror surface.

Clean the mirror using a soft, dry, non-abrasive cloth.

Restore power at the breaker and operate the mirror via the wall switch.

WC-LEDWSDSL2436  
Installation Guide

# WYNDHAM COLLECTION

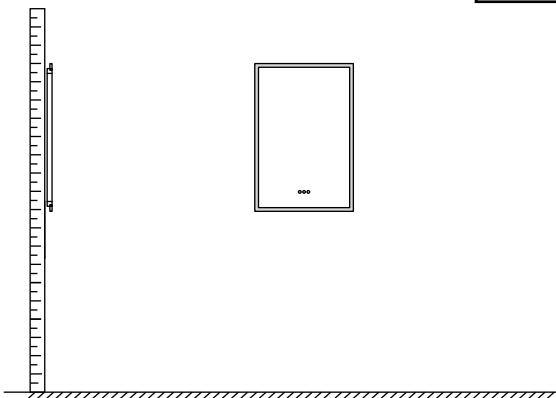

- Prior to installation please check received items against the "Packing List". Please report any missing items to your retailer immediately.
- Protect all surfaces from sharp objects, high heat sources, direct prolonged sunlight and chemical hazards.
- Professional installation recommended.



## BEFORE YOU BEGIN INSTALLATION

Please review the instructions below carefully before starting the installation process. Keep this guide in a safe place for future reference.

- Hire a licensed electrician for all electrical wiring and installation procedures.
- Disconnect all power at the main circuit breaker before installation.
- Inspect the package contents prior to installation and before discarding any packaging.
- This mirror must be hardwired to a dimmable wall switch to use the built-in dimming feature.
- The mechanical switch located on the bottom of the mirror must remain ON when using the wall switch to operate the mirror.
- Note: The defogging feature will automatically disable when the mirror is dimmed.
- Keep the plastic corner protectors in place until installation is fully complete.
- Do NOT strike the mirror glass with hard or pointed items.
- It is recommended to use a soft, dry, non-abrasive cloth to clean the mirror.
- Do NOT use cleaning agents or abrasive materials to clean the mirror.
- Do NOT allow moisture to come into contact with the electrical components.

## IMPORTANT SAFETY INSTRUCTIONS

To reduce the risk of electric shock, injury, or fire, please follow these safety guidelines:

**DANGER - Electrical safety:**

- Disconnect power at the circuit breaker before servicing the mirror.
- Do not allow children, elderly individuals, or those with limited mobility to use the mirror without supervision.
- Use this product only as described in this guide.
- Do not use the mirror if the wiring appears damaged, the product malfunctions during testing, or if it has been dropped or exposed to moisture.
- Keep all cords away from hot surfaces and avoid placing the mirror near heat sources.
- Never insert foreign objects into any openings in the electrical components.
- This mirror is intended for indoor use only.
- To fully disconnect the unit, turn off the wall switch and cut power at the breaker.

**⚠ WARNING: Risk of Electric Shock - This product must be connected to a properly grounded outlet.**

WC-LEDCHM2436  
Installation Guide

# WYNDHAM COLLECTION

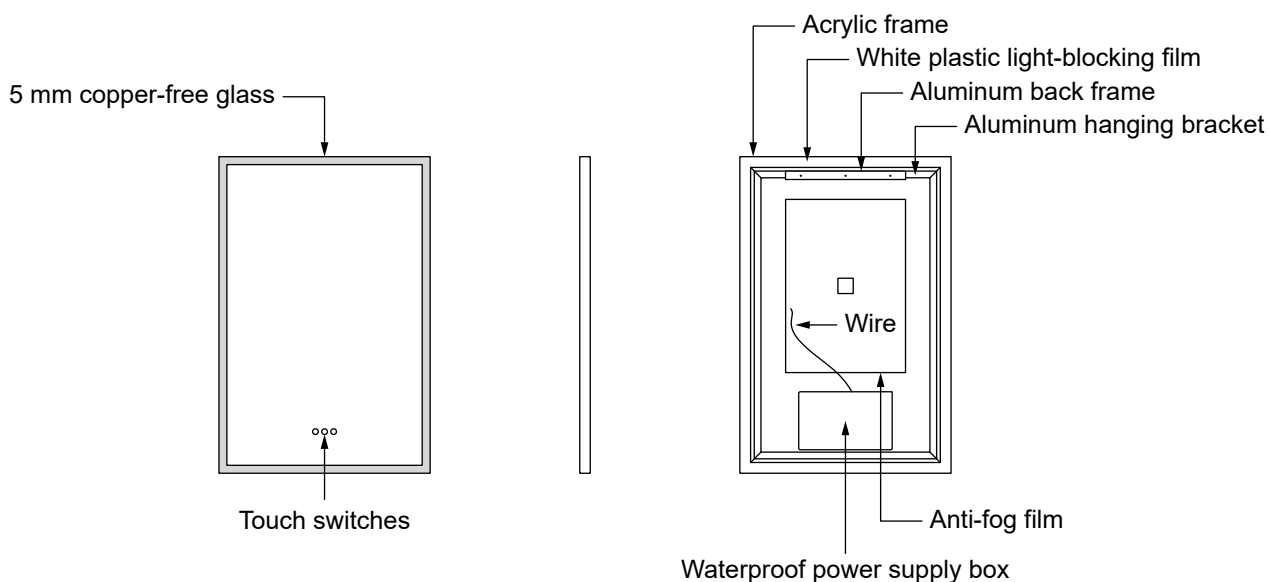

## TOUCH SWITCH INSTRUCTIONS

### LED Light ON/OFF Function

When the LED light is off, lightly touch the switch button to turn it on. When the LED light is on, lightly touch the switch button again to turn it off.

### Dimming Function

Press and hold the touch switch to adjust the brightness to your desired level.

### Color Temperature Adjustment

When the LED light is on, lightly touch the second button to change the color temperature. It will cycle from cool white to neutral white to warm white.

### Memory Function

When the LED light is turned on again, both the brightness and color temperature will return to the same settings as before it was turned off.

### Anti-Fog ON/OFF Function

When the anti-fog function is off, lightly touch the anti-fog switch to activate the heating function. When the anti-fog function is on, lightly touch the switch again to turn off the heating.

WC-LEDCHM2436  
Installation Guide

# WYNDHAM COLLECTION

## PACKING LIST

(Not all components may be included, depending on your purchase)

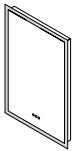

Mirror / 1

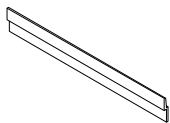

Aluminum hanging  
bracket / 1

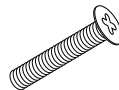

Screws / 2

## REQUIRED TOOLS NOT IN BOX

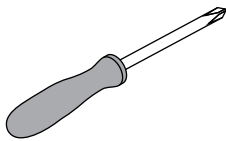

Phillips screwdriver

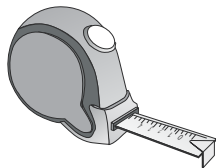

Tape measure

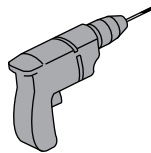

Electric drill



Hammer

WC-LEDCHM2436  
Installation Guide

# WYNDHAM COLLECTION

## INSTALLATION INSTRUCTIONS

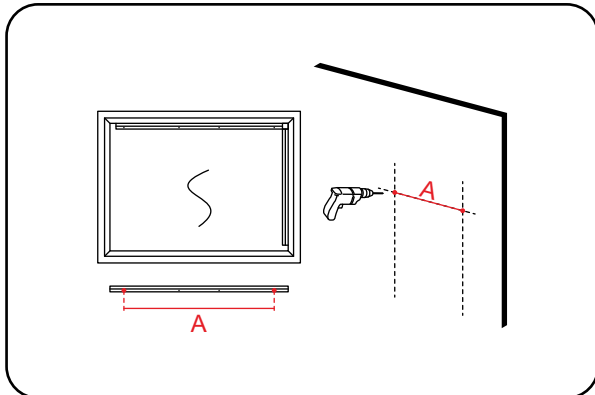

### ① Select Mounting Location

Choose a suitable location for the mirror, ensuring the main electrical supply is accessible and within reach of the mirror's electrical entry point.

The mounting bracket must be secured to a wall stud for proper support.

Measure distance "A" (as indicated in the diagram), and mark the positions for drilling.

Drill holes at the marked points using an appropriate tool.

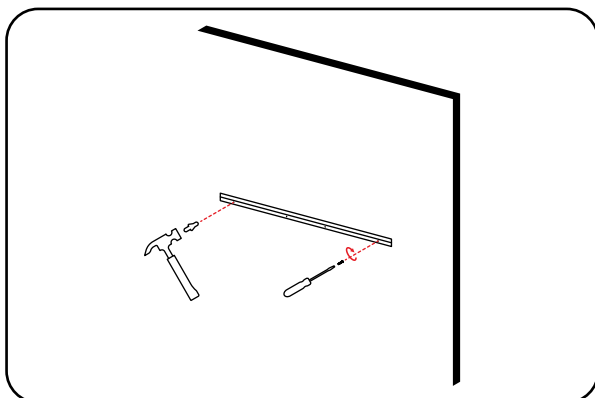

### ② Step 2: Install Wall Plugs & Mounting Bracket

Insert the supplied wall plugs into the drilled holes.

Fasten the mounting bracket securely to the wall using the provided screws.

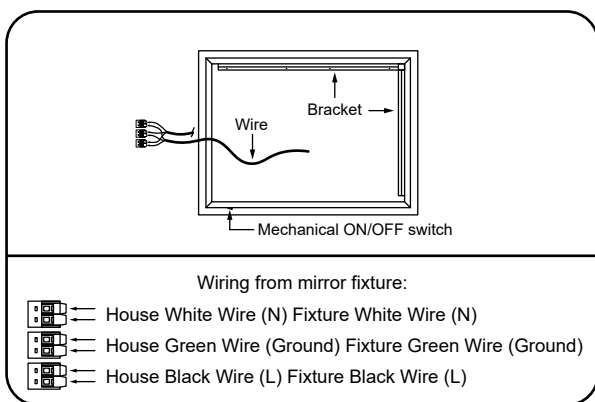

Wiring from mirror fixture:

- House White Wire (N) Fixture White Wire (N)
- House Green Wire (Ground) Fixture Green Wire (Ground)
- House Black Wire (L) Fixture Black Wire (L)

### ③ Step 3: Electrical Wiring

**⚠ Important: Ensure power is turned off at the circuit breaker before beginning any electrical work.**

A junction box must be present inside the wall at the connection point.

Connect the mirror's fixture wires to the house wiring as indicated in the diagram.

Input Voltage: 110V

## WC-LEDCHM2436 Installation Guide



# WYNDHAM COLLECTION

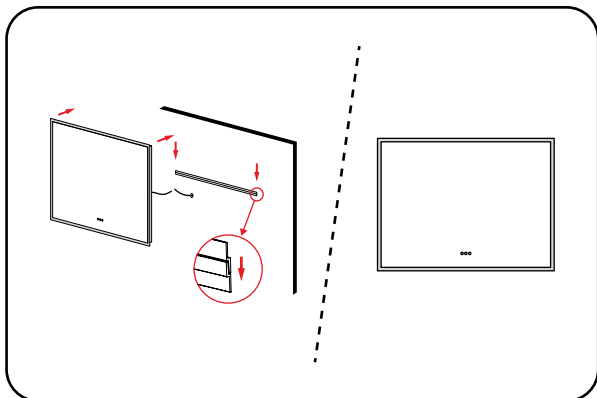

## ④ Step 4: Final Assembly

Carefully hang the mirror on the mounted bracket.

Peel off the protective film from the mirror surface.

Clean the mirror using a soft, dry, non-abrasive cloth.

Restore power at the breaker and operate the mirror via the wall switch.

WC-LEDCHM2436  
Installation Guide

# WYNDHAM COLLECTION

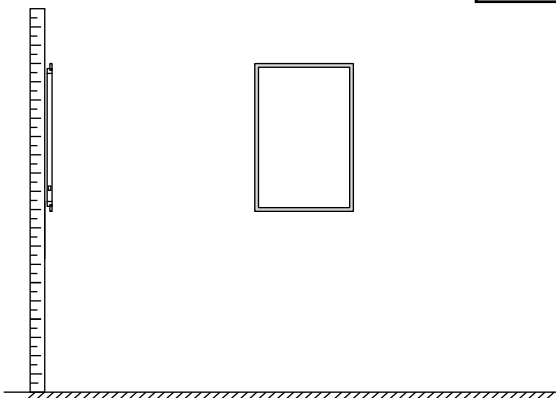

- Prior to installation please check received items against the "Packing List". Please report any missing items to your retailer immediately.
- Protect all surfaces from sharp objects, high heat sources, direct prolonged sunlight and chemical hazards.
- Professional installation recommended.



## BEFORE YOU BEGIN INSTALLATION

Please review the instructions below carefully before starting the installation process. Keep this guide in a safe place for future reference.

- Hire a licensed electrician for all electrical wiring and installation procedures.
- Disconnect all power at the main circuit breaker before installation.
- Inspect the package contents prior to installation and before discarding any packaging.
- This mirror must be hardwired to a dimmable wall switch to use the built-in dimming feature.
- The mechanical switch located on the bottom of the mirror must remain ON when using the wall switch to operate the mirror.
- Note: The defogging feature will automatically disable when the mirror is dimmed.

## IMPORTANT SAFETY INSTRUCTIONS

To reduce the risk of electric shock, injury, or fire, please follow these safety guidelines:

**DANGER - Electrical safety:**

- Disconnect power at the circuit breaker before servicing the mirror.
- Do not allow children, elderly individuals, or those with limited mobility to use the mirror without supervision.
- Use this product only as described in this guide.
- Do not use the mirror if the wiring appears damaged, the product malfunctions during testing, or if it has been dropped or exposed to moisture.
- Keep all cords away from hot surfaces and avoid placing the mirror near heat sources.
- Never insert foreign objects into any openings in the electrical components.
- This mirror is intended for indoor use only.
- To fully disconnect the unit, turn off the wall switch and cut power at the breaker.

**⚠ WARNING: Risk of Electric Shock - This product must be connected to a properly grounded outlet.**

WC-LEDWSDPL3436  
Installation Guide

# WYNDHAM COLLECTION

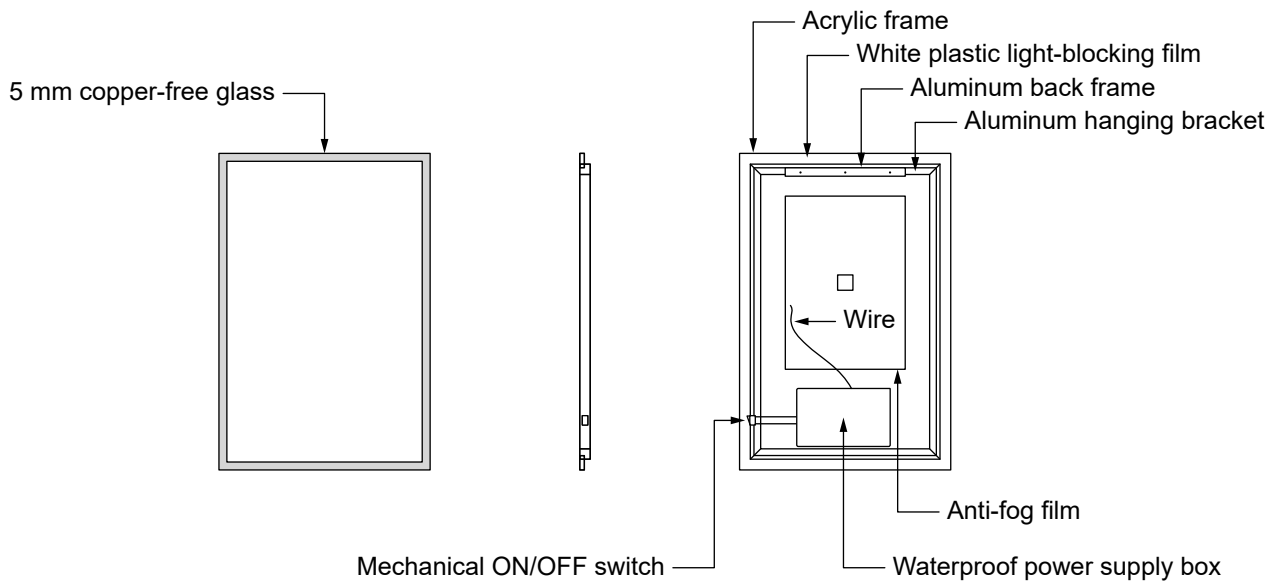

## PACKING LIST

(Not all components may be included, depending on your purchase)

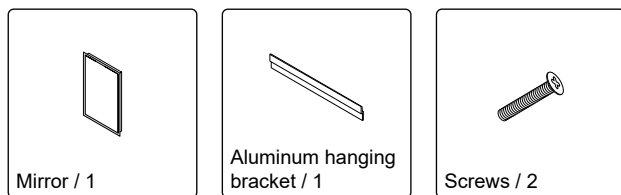

## REQUIRED TOOLS NOT IN BOX

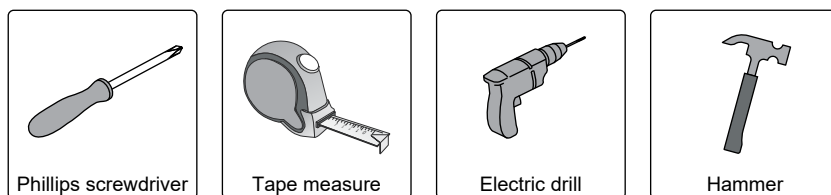

WC-LEDWSDPL3436  
Installation Guide

# WYNDHAM COLLECTION

## INSTALLATION INSTRUCTIONS

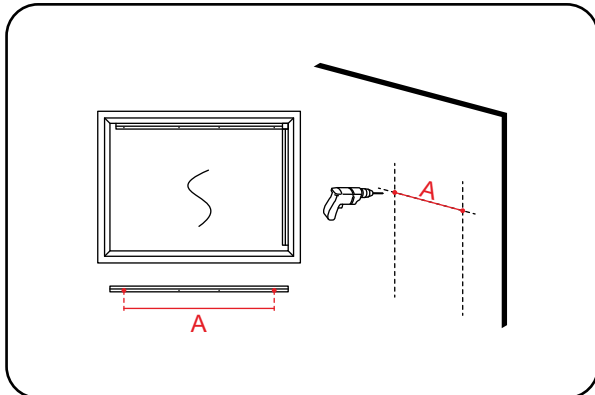

### ① Select Mounting Location

Choose a suitable location for the mirror, ensuring the main electrical supply is accessible and within reach of the mirror's electrical entry point.

The mounting bracket must be secured to a wall stud for proper support.

Measure distance "A" (as indicated in the diagram), and mark the positions for drilling.

Drill holes at the marked points using an appropriate tool.

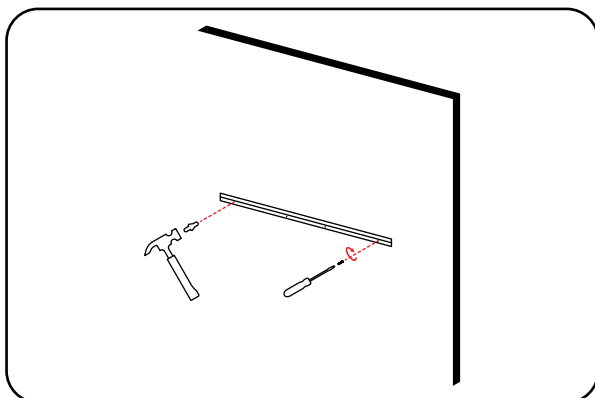

### ② Step 2: Install Wall Plugs & Mounting Bracket

Insert the supplied wall plugs into the drilled holes.

Fasten the mounting bracket securely to the wall using the provided screws.

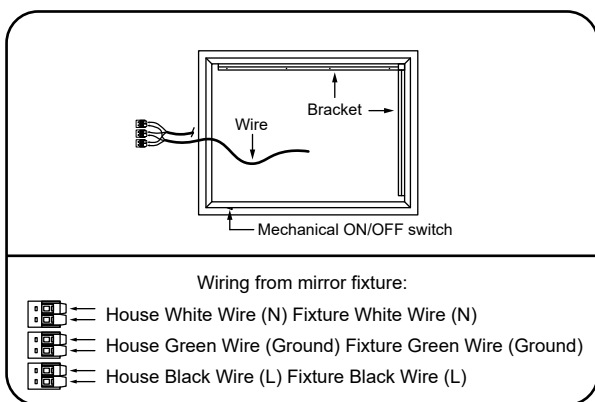

### ③ Step 3: Electrical Wiring

**⚠ Important: Ensure power is turned off at the circuit breaker before beginning any electrical work.**

A junction box must be present inside the wall at the connection point.

Connect the mirror's fixture wires to the house wiring as indicated in the diagram.

Input Voltage: 110V

WC-LEDWSDPL3436  
Installation Guide

# WYNDHAM COLLECTION

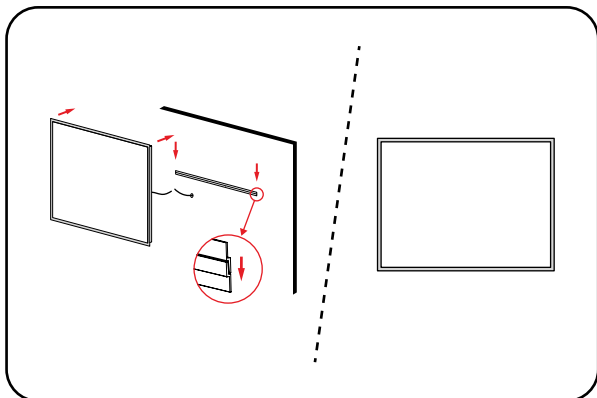

#### ④ Step 4: Final Assembly

Carefully hang the mirror on the mounted bracket.

Peel off the protective film from the mirror surface.

Clean the mirror using a soft, dry, non-abrasive cloth.

Restore power at the breaker and operate the mirror via the wall switch.

WC-LEDWSDPL3436  
Installation Guide

# WYNDHAM COLLECTION

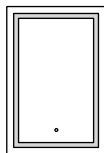

- Prior to installation please check received items against the "Packing List". Please report any missing items to your retailer immediately.
- Protect all surfaces from sharp objects, high heat sources, direct prolonged sunlight and chemical hazards.
- Professional installation recommended.

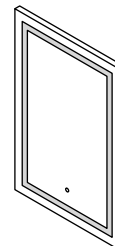

## BEFORE YOU BEGIN INSTALLATION

Please review the instructions below carefully before starting the installation process. Keep this guide in a safe place for future reference.

- Hire a licensed electrician for all electrical wiring and installation procedures.
- Disconnect all power at the main circuit breaker before installation.
- Inspect the package contents prior to installation and before discarding any packaging.
- This mirror must be hardwired to a dimmable wall switch to use the built-in dimming feature.
- The mechanical switch located on the bottom of the mirror must remain ON when using the wall switch to operate the mirror.
- Note: The defogging feature will automatically disable when the mirror is dimmed.
- Keep the plastic corner protectors in place until installation is fully complete.
- Do NOT strike the mirror glass with hard or pointed items.
- It is recommended to use a soft, dry, non-abrasive cloth to clean the mirror.
- Do NOT use cleaning agents or abrasive materials to clean the mirror.
- Do NOT allow moisture to come into contact with the electrical components.

## IMPORTANT SAFETY INSTRUCTIONS

To reduce the risk of electric shock, injury, or fire, please follow these safety guidelines:

**DANGER - Electrical safety:**

- Disconnect power at the circuit breaker before servicing the mirror.
- Do not allow children, elderly individuals, or those with limited mobility to use the mirror without supervision.
- Use this product only as described in this guide.
- Do not use the mirror if the wiring appears damaged, the product malfunctions during testing, or if it has been dropped or exposed to moisture.
- Keep all cords away from hot surfaces and avoid placing the mirror near heat sources.
- Never insert foreign objects into any openings in the electrical components.
- This mirror is intended for indoor use only.
- To fully disconnect the unit, turn off the wall switch and cut power at the breaker.

**⚠ WARNING: Risk of Electric Shock - This product must be connected to a properly grounded outlet.**

WC-LEDALM7036  
Installation Guide

# WYNDHAM COLLECTION

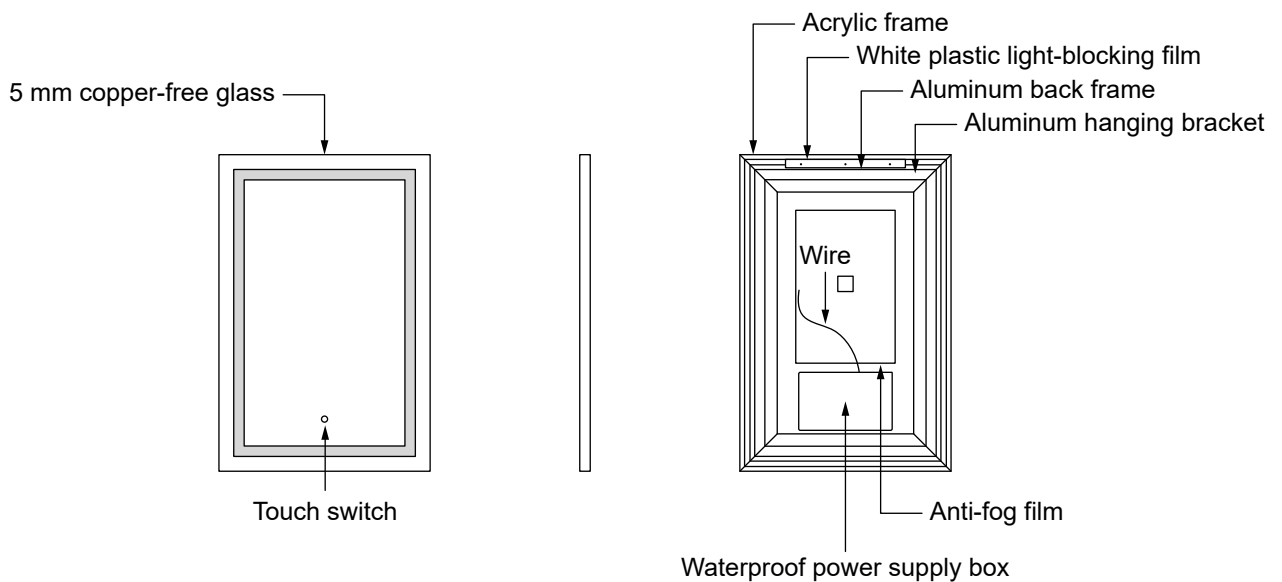

## TOUCH SWITCH INSTRUCTIONS

### LED Light ON/OFF Function

When the LED light is off, lightly touch the switch button to turn it on. When the LED light is on, lightly touch the switch button again to turn it off.

### Dimming Function

Press and hold the touch switch to adjust the brightness to your desired level.

### Memory Function

When the LED light is turned on again, both the brightness and color temperature will return to the same settings as before it was turned off.

WC-LEDALM7036  
Installation Guide

# WYNDHAM COLLECTION

## PACKING LIST

(Not all components may be included, depending on your purchase)

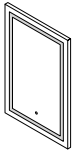

Mirror / 1

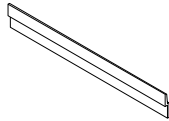

Aluminum hanging  
bracket / 1

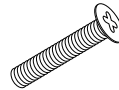

Screws / 2

## REQUIRED TOOLS NOT IN BOX

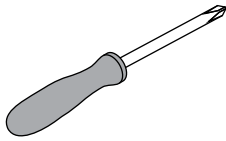

Phillips screwdriver

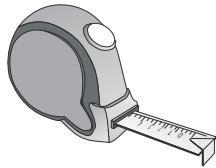

Tape measure

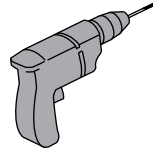

Electric drill



Hammer

WC-LEDALM7036  
Installation Guide



# WYNDHAM COLLECTION

## INSTALLATION INSTRUCTIONS

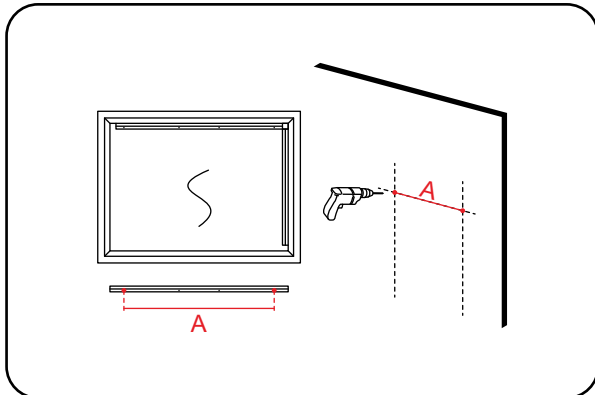

### ① Select Mounting Location

Choose a suitable location for the mirror, ensuring the main electrical supply is accessible and within reach of the mirror's electrical entry point.

The mounting bracket must be secured to a wall stud for proper support.

Measure distance "A" (as indicated in the diagram), and mark the positions for drilling.

Drill holes at the marked points using an appropriate tool.

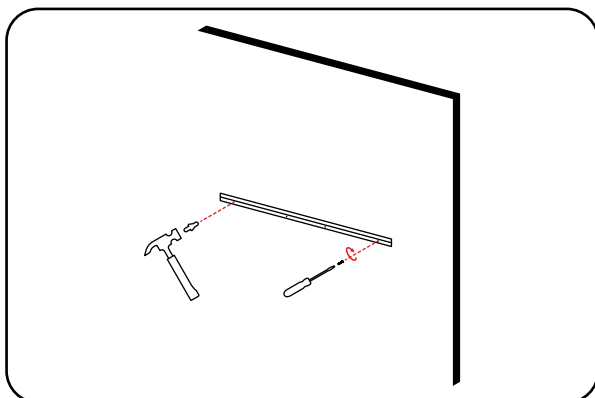

### ② Step 2: Install Wall Plugs & Mounting Bracket

Insert the supplied wall plugs into the drilled holes.

Fasten the mounting bracket securely to the wall using the provided screws.

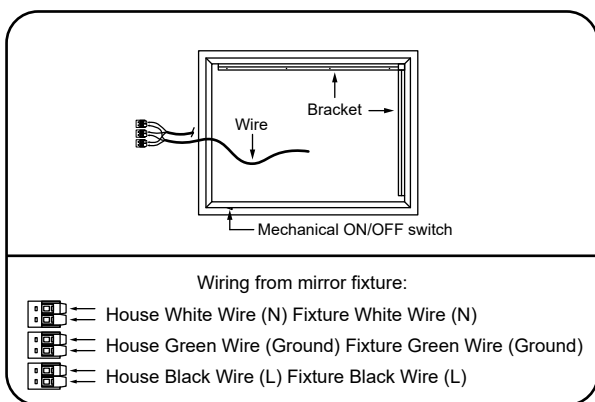

### ③ Step 3: Electrical Wiring

**⚠ Important: Ensure power is turned off at the circuit breaker before beginning any electrical work.**

A junction box must be present inside the wall at the connection point.

Connect the mirror's fixture wires to the house wiring as indicated in the diagram.

Input Voltage: 110V

## WC-LEDALM7036 Installation Guide

# WYNDHAM COLLECTION

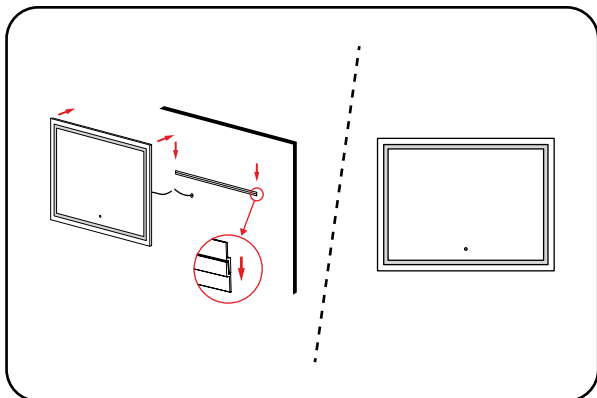

#### ④ Step 4: Final Assembly

Carefully hang the mirror on the mounted bracket.

Peel off the protective film from the mirror surface.

Clean the mirror using a soft, dry, non-abrasive cloth.

Restore power at the breaker and operate the mirror via the wall switch.

WC-LEDALM7036  
Installation Guide

# WYNDHAM COLLECTION

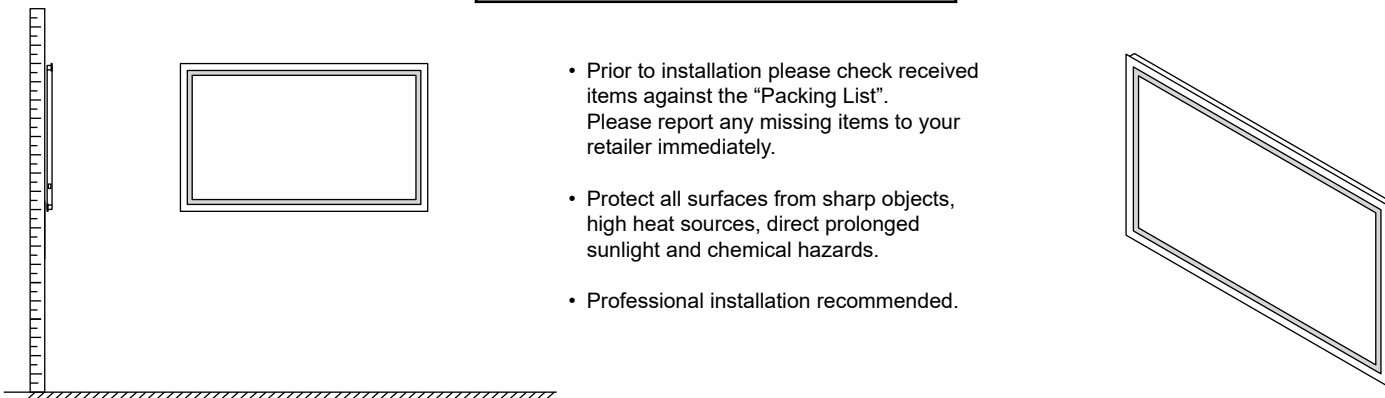

- Prior to installation please check received items against the "Packing List". Please report any missing items to your retailer immediately.
- Protect all surfaces from sharp objects, high heat sources, direct prolonged sunlight and chemical hazards.
- Professional installation recommended.

## BEFORE YOU BEGIN INSTALLATION

Please review the instructions below carefully before starting the installation process. Keep this guide in a safe place for future reference.

- Hire a licensed electrician for all electrical wiring and installation procedures.
- Disconnect all power at the main circuit breaker before installation.
- Inspect the package contents prior to installation and before discarding any packaging.
- This mirror must be hardwired to a dimmable wall switch to use the built-in dimming feature.
- The mechanical switch located on the bottom of the mirror must remain ON when using the wall switch to operate the mirror.
- Note: The defogging feature will automatically disable when the mirror is dimmed.

## IMPORTANT SAFETY INSTRUCTIONS

To reduce the risk of electric shock, injury, or fire, please follow these safety guidelines:

**DANGER** - Electrical safety:

- Disconnect power at the circuit breaker before servicing the mirror.
- Do not allow children, elderly individuals, or those with limited mobility to use the mirror without supervision.
- Use this product only as described in this guide.
- Do not use the mirror if the wiring appears damaged, the product malfunctions during testing, or if it has been dropped or exposed to moisture.
- Keep all cords away from hot surfaces and avoid placing the mirror near heat sources.
- Never insert foreign objects into any openings in the electrical components.
- This mirror is intended for indoor use only.
- To fully disconnect the unit, turn off the wall switch and cut power at the breaker.

**⚠ WARNING: Risk of Electric Shock - This product must be connected to a properly grounded outlet.**

WC-LEDWSDSL6036  
Installation Guide

# WYNDHAM COLLECTION

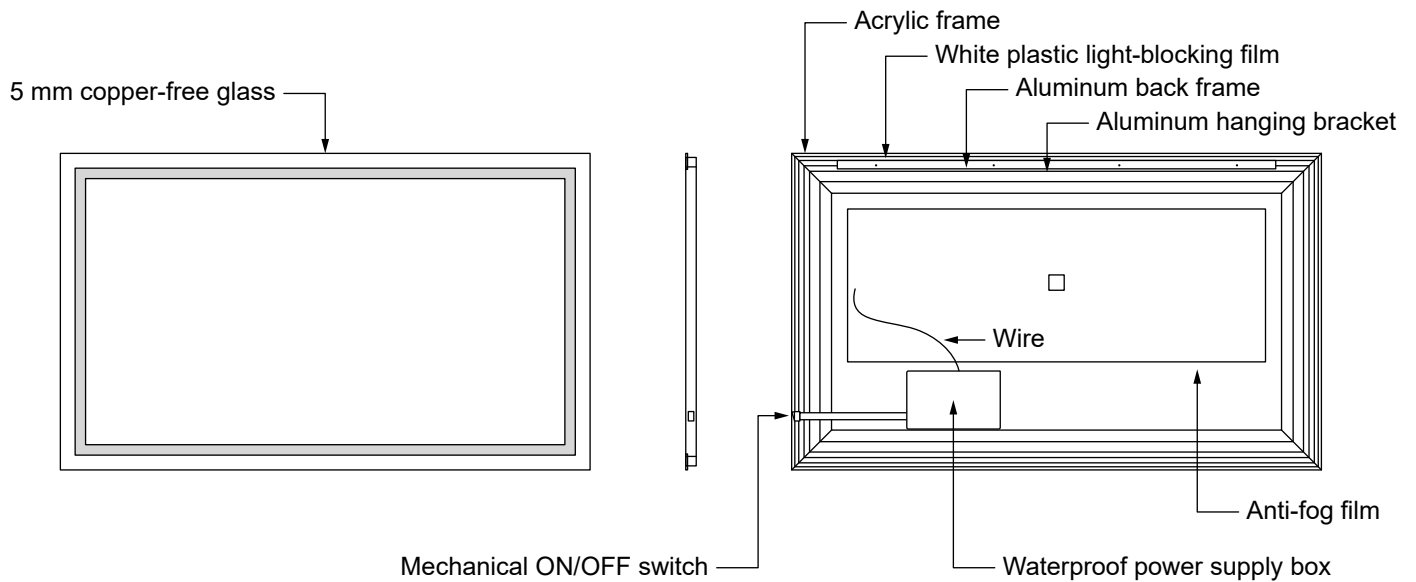

## PACKING LIST

(Not all components may be included, depending on your purchase)

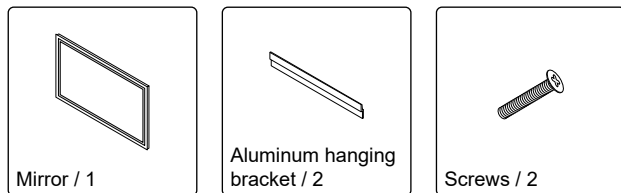

## REQUIRED TOOLS NOT IN BOX

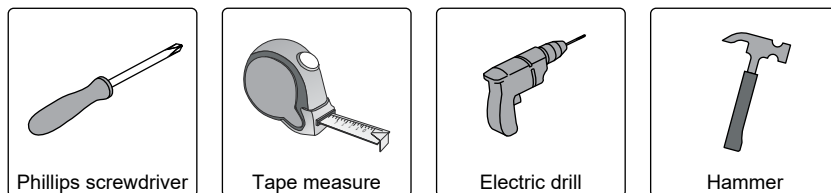

WC-LEDWSDSL6036  
Installation Guide

# WYNDHAM COLLECTION

## INSTALLATION INSTRUCTIONS

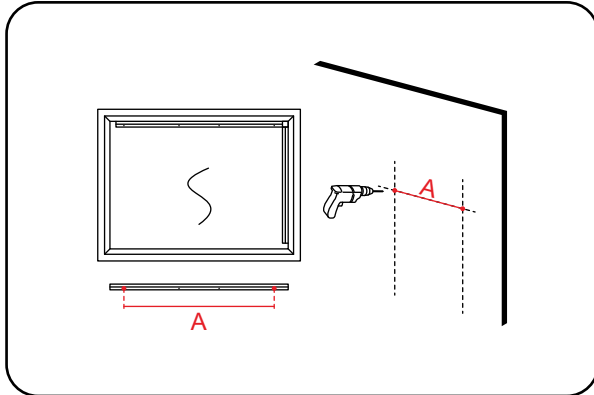

### ① Select Mounting Location

Choose a suitable location for the mirror, ensuring the main electrical supply is accessible and within reach of the mirror's electrical entry point.

The mounting bracket must be secured to a wall stud for proper support.

Measure distance "A" (as indicated in the diagram), and mark the positions for drilling.

Drill holes at the marked points using an appropriate tool.

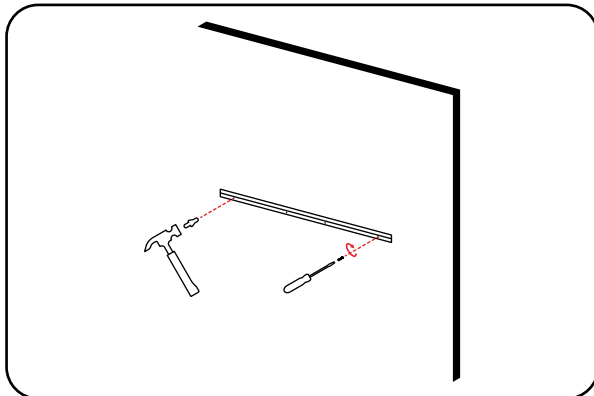

### ② Step 2: Install Wall Plugs & Mounting Bracket

Insert the supplied wall plugs into the drilled holes.

Fasten the mounting bracket securely to the wall using the provided screws.

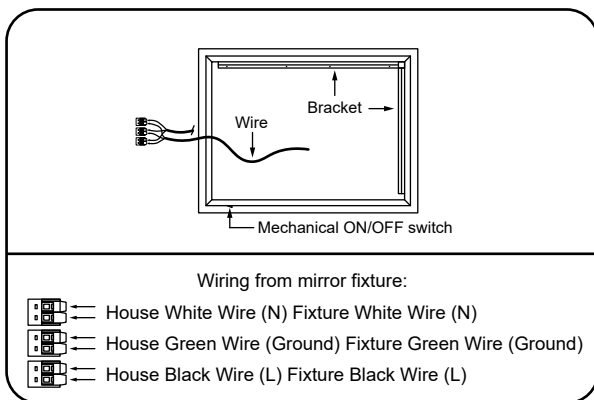

Wiring from mirror fixture:

- House White Wire (N) Fixture White Wire (N)
- House Green Wire (Ground) Fixture Green Wire (Ground)
- House Black Wire (L) Fixture Black Wire (L)

### ③ Step 3: Electrical Wiring

**⚠ Important: Ensure power is turned off at the circuit breaker before beginning any electrical work.**

A junction box must be present inside the wall at the connection point.

Connect the mirror's fixture wires to the house wiring as indicated in the diagram.

Input Voltage: 110V

WC-LEDWSDSL6036  
Installation Guide

# WYNDHAM COLLECTION

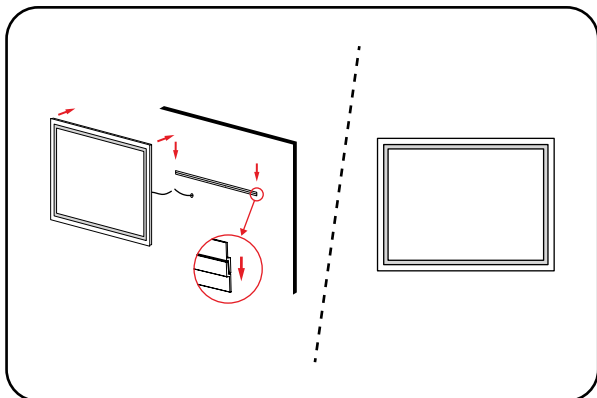

## ④ Step 4: Final Assembly

Carefully hang the mirror on the mounted bracket.

Peel off the protective film from the mirror surface.

Clean the mirror using a soft, dry, non-abrasive cloth.

Restore power at the breaker and operate the mirror via the wall switch.

WC-LEDWSDSL6036  
Installation Guide

# WYNDHAM COLLECTION

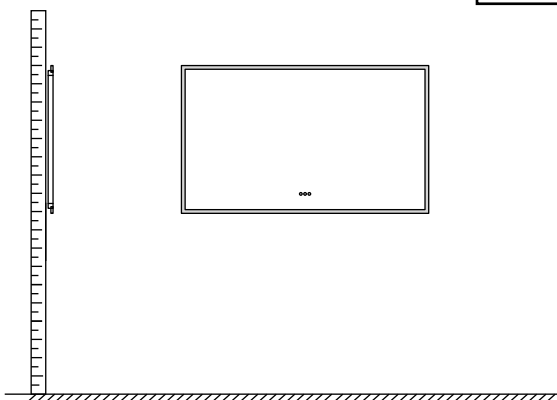

- Prior to installation please check received items against the "Packing List". Please report any missing items to your retailer immediately.
- Protect all surfaces from sharp objects, high heat sources, direct prolonged sunlight and chemical hazards.
- Professional installation recommended.

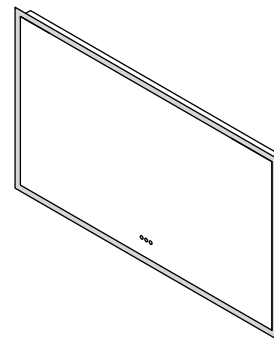

## BEFORE YOU BEGIN INSTALLATION

Please review the instructions below carefully before starting the installation process. Keep this guide in a safe place for future reference.

- Hire a licensed electrician for all electrical wiring and installation procedures.
- Disconnect all power at the main circuit breaker before installation.
- Inspect the package contents prior to installation and before discarding any packaging.
- This mirror must be hardwired to a dimmable wall switch to use the built-in dimming feature.
- The mechanical switch located on the bottom of the mirror must remain ON when using the wall switch to operate the mirror.
- Note: The defogging feature will automatically disable when the mirror is dimmed.
- Keep the plastic corner protectors in place until installation is fully complete.
- Do NOT strike the mirror glass with hard or pointed items.
- It is recommended to use a soft, dry, non-abrasive cloth to clean the mirror.
- Do NOT use cleaning agents or abrasive materials to clean the mirror.
- Do NOT allow moisture to come into contact with the electrical components.

## IMPORTANT SAFETY INSTRUCTIONS

To reduce the risk of electric shock, injury, or fire, please follow these safety guidelines:

**DANGER - Electrical safety:**

- Disconnect power at the circuit breaker before servicing the mirror.
- Do not allow children, elderly individuals, or those with limited mobility to use the mirror without supervision.
- Use this product only as described in this guide.
- Do not use the mirror if the wiring appears damaged, the product malfunctions during testing, or if it has been dropped or exposed to moisture.
- Keep all cords away from hot surfaces and avoid placing the mirror near heat sources.
- Never insert foreign objects into any openings in the electrical components.
- This mirror is intended for indoor use only.
- To fully disconnect the unit, turn off the wall switch and cut power at the breaker.

**⚠ WARNING: Risk of Electric Shock - This product must be connected to a properly grounded outlet.**

WC-LEDCHM6036  
Installation Guide

# WYNDHAM COLLECTION

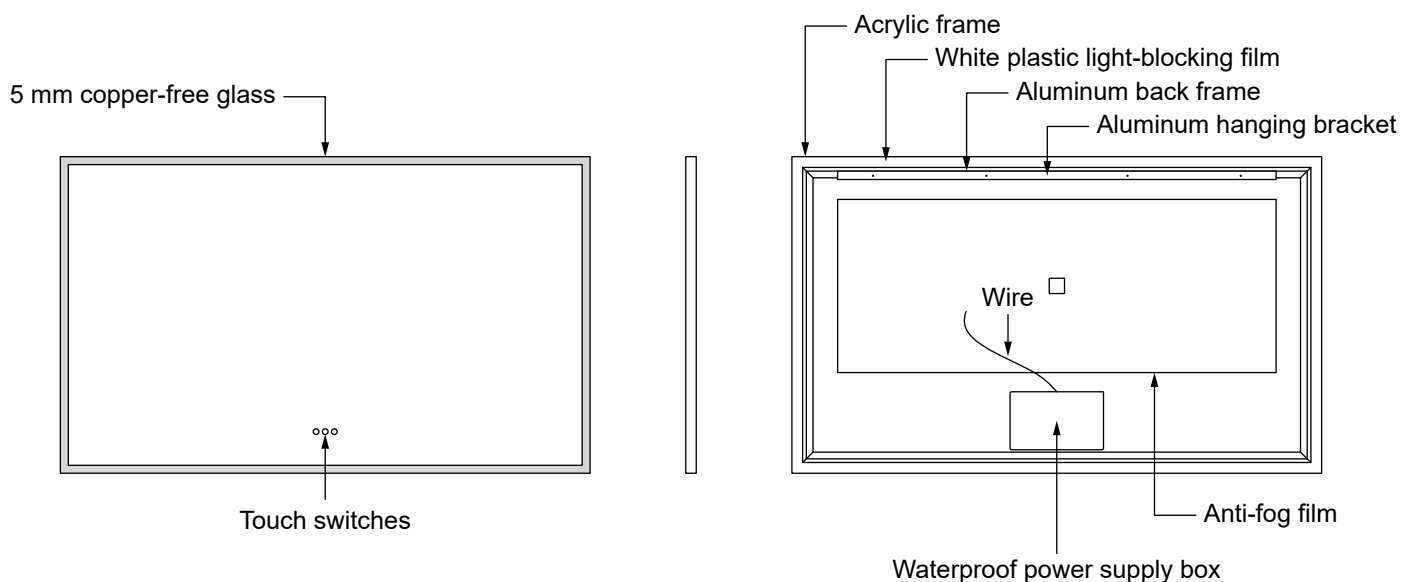

## TOUCH SWITCH INSTRUCTIONS

### LED Light ON/OFF Function

When the LED light is off, lightly touch the switch button to turn it on. When the LED light is on, lightly touch the switch button again to turn it off.

### Dimming Function

Press and hold the touch switch to adjust the brightness to your desired level.

### Color Temperature Adjustment

When the LED light is on, lightly touch the second button to change the color temperature. It will cycle from cool white to neutral white to warm white.

### Memory Function

When the LED light is turned on again, both the brightness and color temperature will return to the same settings as before it was turned off.

### Anti-Fog ON/OFF Function

When the anti-fog function is off, lightly touch the anti-fog switch to activate the heating function. When the anti-fog function is on, lightly touch the switch again to turn off the heating.

WC-LEDCHM6036  
Installation Guide



# WYNDHAM COLLECTION

## PACKING LIST

(Not all components may be included, depending on your purchase)

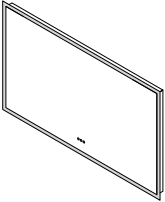

Mirror / 1

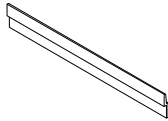

Aluminum hanging  
bracket / 2

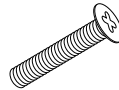

Screws / 2

## REQUIRED TOOLS NOT IN BOX

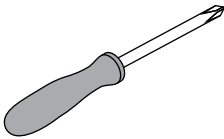

Phillips screwdriver

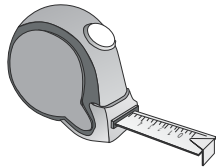

Tape measure

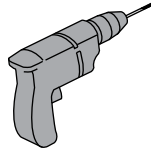

Electric drill



Hammer

WC-LEDCHM6036  
Installation Guide

# WYNDHAM COLLECTION

## INSTALLATION INSTRUCTIONS

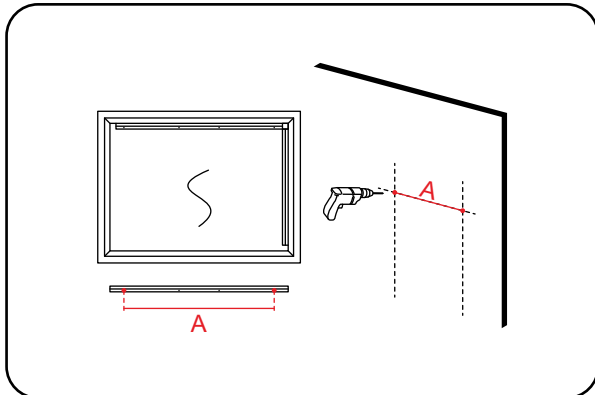

### ① Select Mounting Location

Choose a suitable location for the mirror, ensuring the main electrical supply is accessible and within reach of the mirror's electrical entry point.

The mounting bracket must be secured to a wall stud for proper support.

Measure distance "A" (as indicated in the diagram), and mark the positions for drilling.

Drill holes at the marked points using an appropriate tool.

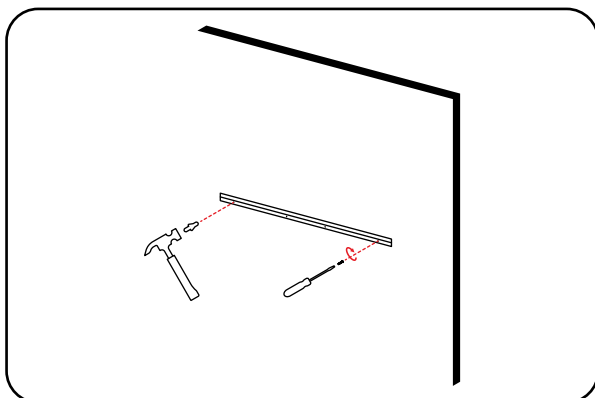

### ② Step 2: Install Wall Plugs & Mounting Bracket

Insert the supplied wall plugs into the drilled holes.

Fasten the mounting bracket securely to the wall using the provided screws.

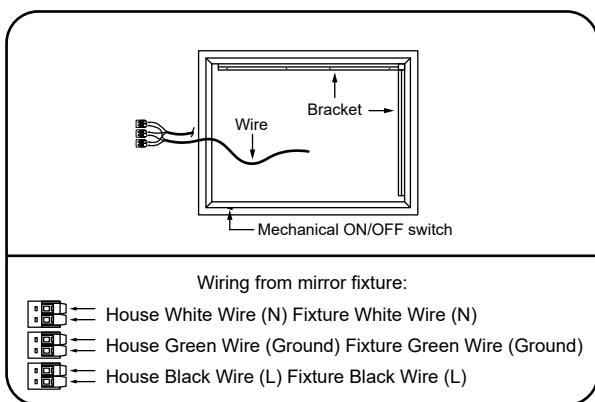

### ③ Step 3: Electrical Wiring

**⚠ Important: Ensure power is turned off at the circuit breaker before beginning any electrical work.**

A junction box must be present inside the wall at the connection point.

Connect the mirror's fixture wires to the house wiring as indicated in the diagram.

Input Voltage: 110V

## WC-LEDCHM6036 Installation Guide

# WYNDHAM COLLECTION

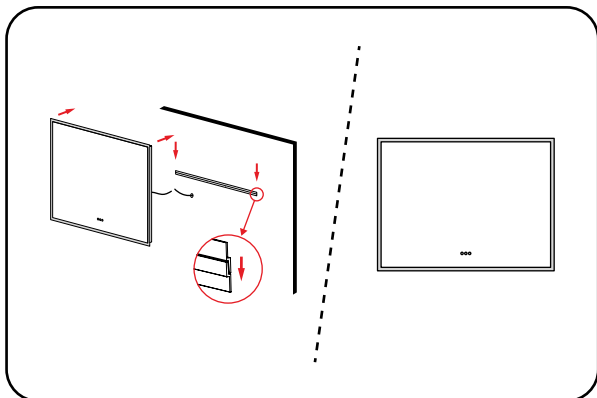

#### ④ Step 4: Final Assembly

Carefully hang the mirror on the mounted bracket.

Peel off the protective film from the mirror surface.

Clean the mirror using a soft, dry, non-abrasive cloth.

Restore power at the breaker and operate the mirror via the wall switch.

WC-LEDCHM6036  
Installation Guide

# WYNDHAM COLLECTION

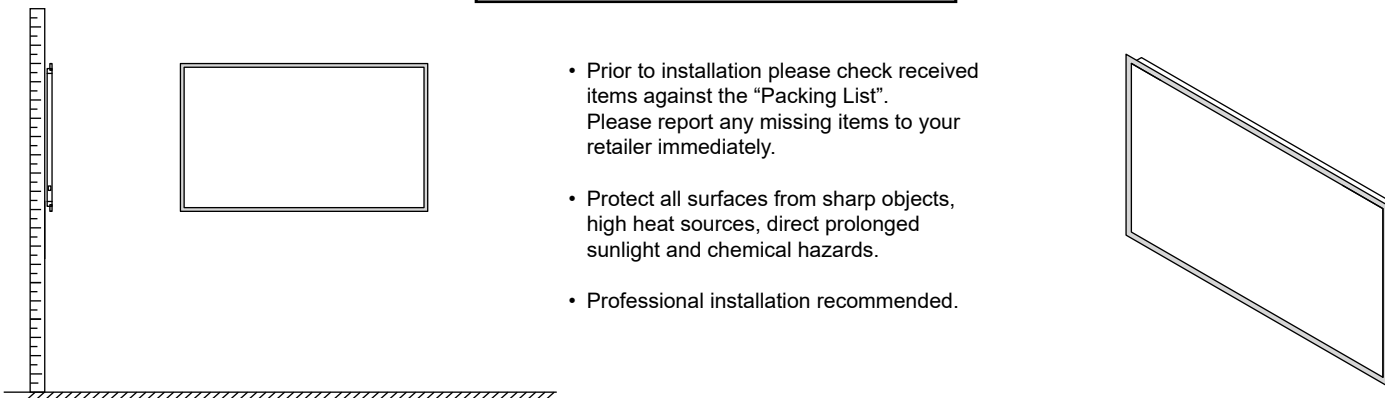

- Prior to installation please check received items against the "Packing List". Please report any missing items to your retailer immediately.
- Protect all surfaces from sharp objects, high heat sources, direct prolonged sunlight and chemical hazards.
- Professional installation recommended.

## BEFORE YOU BEGIN INSTALLATION

Please review the instructions below carefully before starting the installation process. Keep this guide in a safe place for future reference.

- Hire a licensed electrician for all electrical wiring and installation procedures.
- Disconnect all power at the main circuit breaker before installation.
- Inspect the package contents prior to installation and before discarding any packaging.
- This mirror must be hardwired to a dimmable wall switch to use the built-in dimming feature.
- The mechanical switch located on the bottom of the mirror must remain ON when using the wall switch to operate the mirror.
- Note: The defogging feature will automatically disable when the mirror is dimmed.

## IMPORTANT SAFETY INSTRUCTIONS

To reduce the risk of electric shock, injury, or fire, please follow these safety guidelines:

**DANGER - Electrical safety:**

- Disconnect power at the circuit breaker before servicing the mirror.
- Do not allow children, elderly individuals, or those with limited mobility to use the mirror without supervision.
- Use this product only as described in this guide.
- Do not use the mirror if the wiring appears damaged, the product malfunctions during testing, or if it has been dropped or exposed to moisture.
- Keep all cords away from hot surfaces and avoid placing the mirror near heat sources.
- Never insert foreign objects into any openings in the electrical components.
- This mirror is intended for indoor use only.
- To fully disconnect the unit, turn off the wall switch and cut power at the breaker.

**⚠ WARNING: Risk of Electric Shock - This product must be connected to a properly grounded outlet.**

WC-LEDWSDPL6036  
Installation Guide

# WYNDHAM COLLECTION

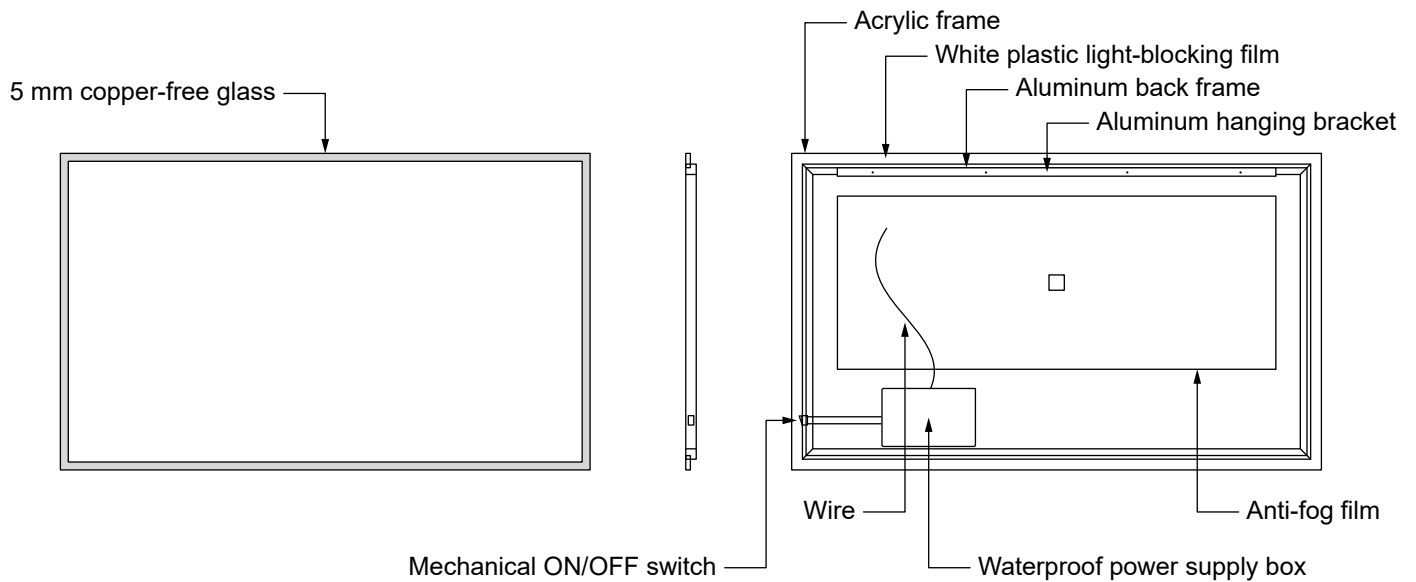

## PACKING LIST

(Not all components may be included, depending on your purchase)

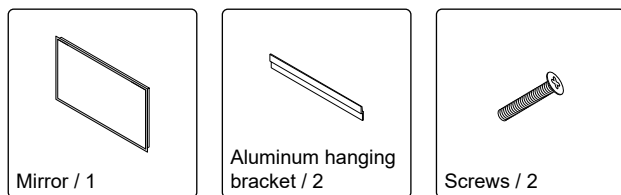

## REQUIRED TOOLS NOT IN BOX

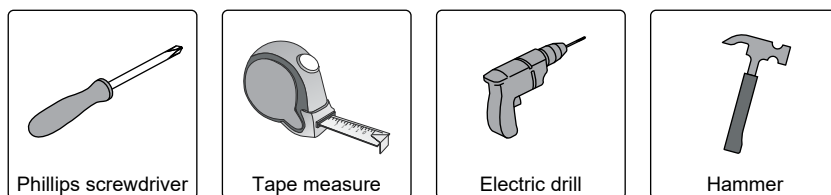

WC-LEDWSDPL6036  
Installation Guide

# WYNDHAM COLLECTION

## INSTALLATION INSTRUCTIONS

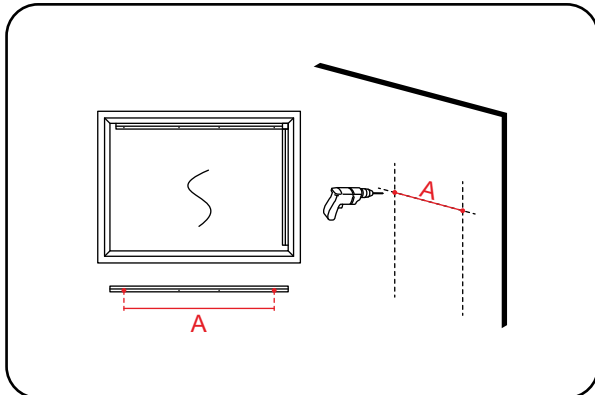

### ① Select Mounting Location

Choose a suitable location for the mirror, ensuring the main electrical supply is accessible and within reach of the mirror's electrical entry point.

The mounting bracket must be secured to a wall stud for proper support.

Measure distance "A" (as indicated in the diagram), and mark the positions for drilling.

Drill holes at the marked points using an appropriate tool.

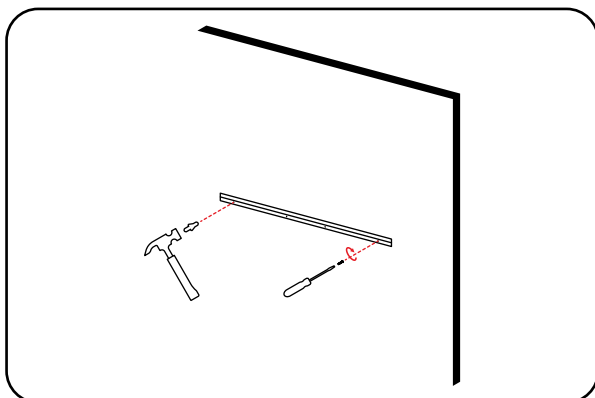

### ② Step 2: Install Wall Plugs & Mounting Bracket

Insert the supplied wall plugs into the drilled holes.

Fasten the mounting bracket securely to the wall using the provided screws.

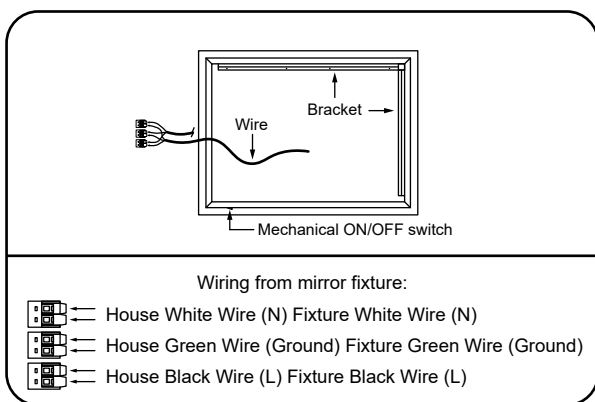

Wiring from mirror fixture:

- House White Wire (N) Fixture White Wire (N)
- House Green Wire (Ground) Fixture Green Wire (Ground)
- House Black Wire (L) Fixture Black Wire (L)

### ③ Step 3: Electrical Wiring

**⚠ Important: Ensure power is turned off at the circuit breaker before beginning any electrical work.**

A junction box must be present inside the wall at the connection point.

Connect the mirror's fixture wires to the house wiring as indicated in the diagram.

Input Voltage: 110V

## WC-LEDWSDPL6036 Installation Guide

# WYNDHAM COLLECTION

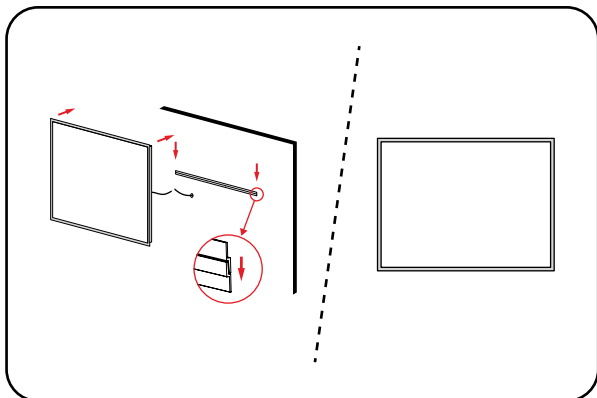

#### ④ Step 4: Final Assembly

Carefully hang the mirror on the mounted bracket.

Peel off the protective film from the mirror surface.

Clean the mirror using a soft, dry, non-abrasive cloth.

Restore power at the breaker and operate the mirror via the wall switch.

WC-LEDWSDPL6036  
Installation Guide

# WYNDHAM COLLECTION

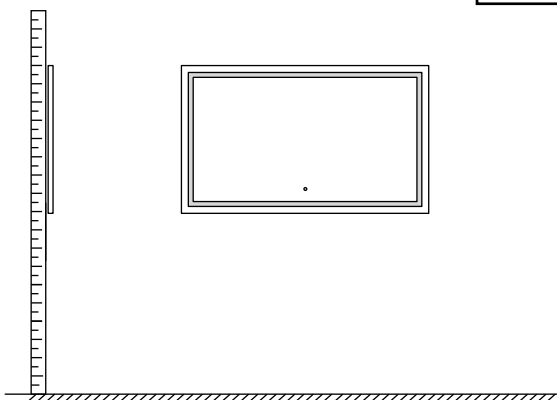

- Prior to installation please check received items against the "Packing List". Please report any missing items to your retailer immediately.
- Protect all surfaces from sharp objects, high heat sources, direct prolonged sunlight and chemical hazards.
- Professional installation recommended.

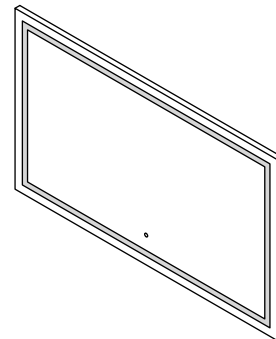

## BEFORE YOU BEGIN INSTALLATION

Please review the instructions below carefully before starting the installation process. Keep this guide in a safe place for future reference.

- Hire a licensed electrician for all electrical wiring and installation procedures.
- Disconnect all power at the main circuit breaker before installation.
- Inspect the package contents prior to installation and before discarding any packaging.
- This mirror must be hardwired to a dimmable wall switch to use the built-in dimming feature.
- The mechanical switch located on the bottom of the mirror must remain ON when using the wall switch to operate the mirror.
- Note: The defogging feature will automatically disable when the mirror is dimmed.
- Keep the plastic corner protectors in place until installation is fully complete.
- Do NOT strike the mirror glass with hard or pointed items.
- It is recommended to use a soft, dry, non-abrasive cloth to clean the mirror.
- Do NOT use cleaning agents or abrasive materials to clean the mirror.
- Do NOT allow moisture to come into contact with the electrical components.

## IMPORTANT SAFETY INSTRUCTIONS

To reduce the risk of electric shock, injury, or fire, please follow these safety guidelines:

**DANGER** - Electrical safety:

- Disconnect power at the circuit breaker before servicing the mirror.
- Do not allow children, elderly individuals, or those with limited mobility to use the mirror without supervision.
- Use this product only as described in this guide.
- Do not use the mirror if the wiring appears damaged, the product malfunctions during testing, or if it has been dropped or exposed to moisture.
- Keep all cords away from hot surfaces and avoid placing the mirror near heat sources.
- Never insert foreign objects into any openings in the electrical components.
- This mirror is intended for indoor use only.
- To fully disconnect the unit, turn off the wall switch and cut power at the breaker.

**⚠ WARNING: Risk of Electric Shock - This product must be connected to a properly grounded outlet.**

WC-LEDALM7036  
Installation Guide



# WYNDHAM COLLECTION

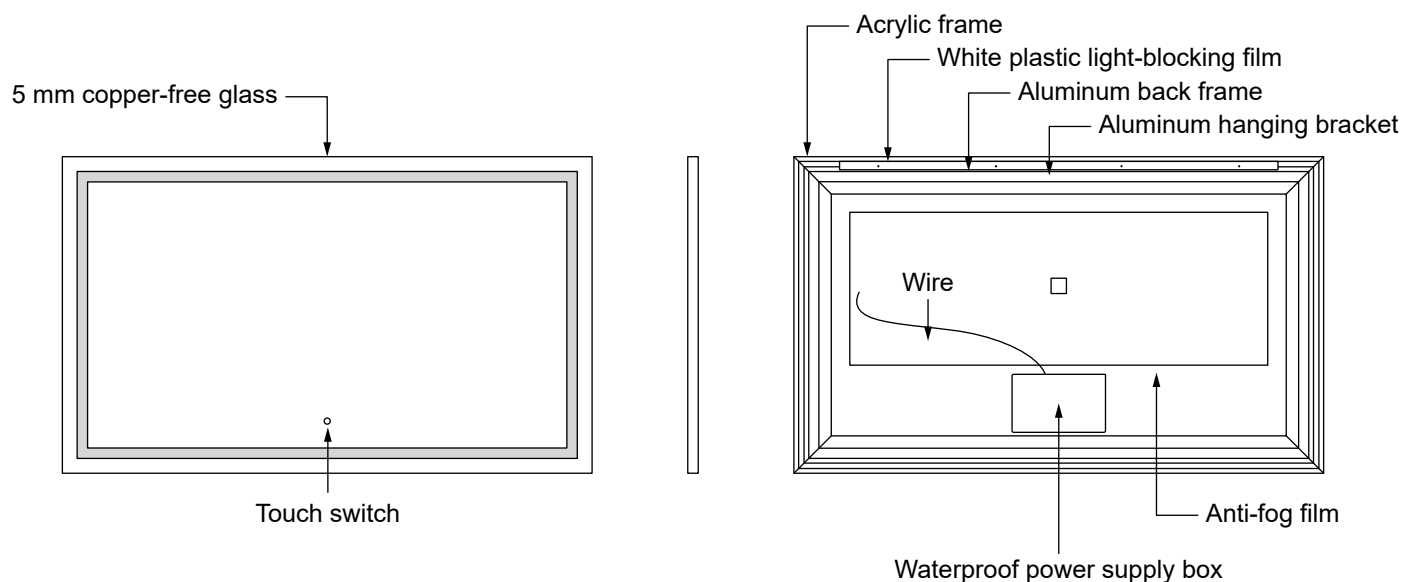

## TOUCH SWITCH INSTRUCTIONS

### LED Light ON/OFF Function

When the LED light is off, lightly touch the switch button to turn it on. When the LED light is on, lightly touch the switch button again to turn it off.

### Dimming Function

Press and hold the touch switch to adjust the brightness to your desired level.

### Memory Function

When the LED light is turned on again, both the brightness and color temperature will return to the same settings as before it was turned off.

WC-LEDALM7036  
Installation Guide

# WYNDHAM COLLECTION

## PACKING LIST

(Not all components may be included, depending on your purchase)

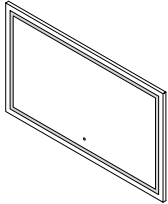

Mirror / 1

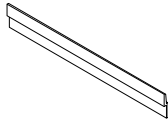

Aluminum hanging  
bracket / 2

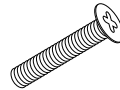

Screws / 2

## REQUIRED TOOLS NOT IN BOX

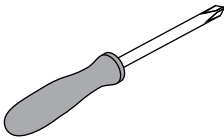

Phillips screwdriver

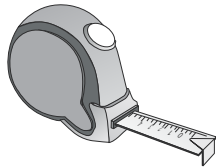

Tape measure

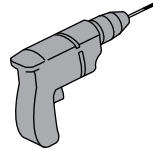

Electric drill



Hammer

WC-LEDALM7036  
Installation Guide

# WYNDHAM COLLECTION

## INSTALLATION INSTRUCTIONS

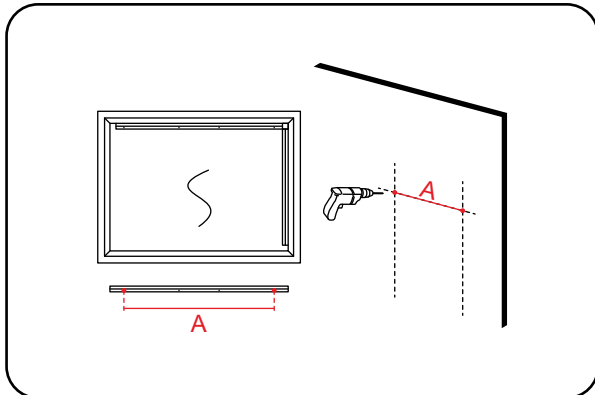

### ① Select Mounting Location

Choose a suitable location for the mirror, ensuring the main electrical supply is accessible and within reach of the mirror's electrical entry point.

The mounting bracket must be secured to a wall stud for proper support.

Measure distance "A" (as indicated in the diagram), and mark the positions for drilling.

Drill holes at the marked points using an appropriate tool.

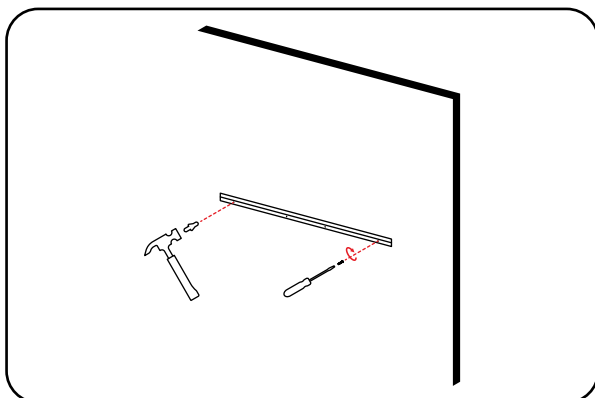

### ② Step 2: Install Wall Plugs & Mounting Bracket

Insert the supplied wall plugs into the drilled holes.

Fasten the mounting bracket securely to the wall using the provided screws.

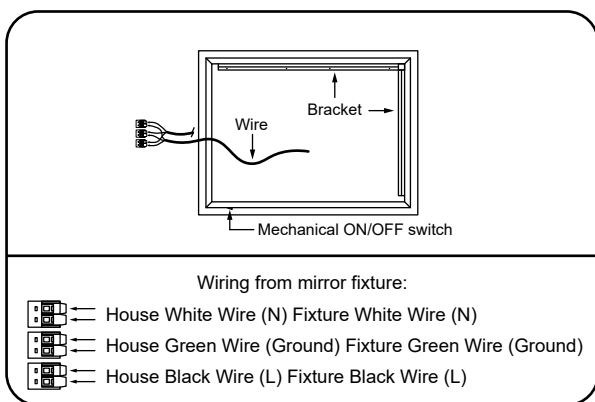

### ③ Step 3: Electrical Wiring

**⚠ Important: Ensure power is turned off at the circuit breaker before beginning any electrical work.**

A junction box must be present inside the wall at the connection point.

Connect the mirror's fixture wires to the house wiring as indicated in the diagram.

Input Voltage: 110V

## WC-LEDALM7036 Installation Guide

# WYNDHAM COLLECTION

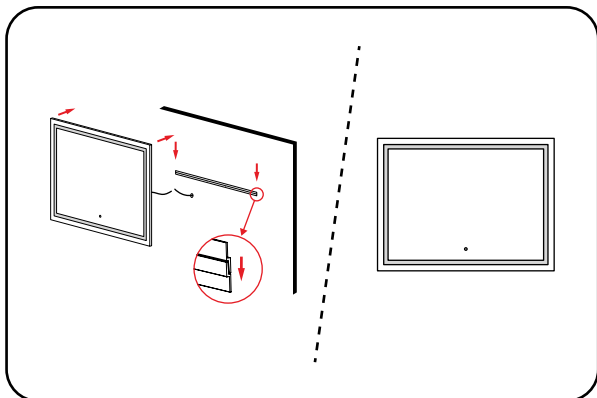

#### ④ Step 4: Final Assembly

Carefully hang the mirror on the mounted bracket.

Peel off the protective film from the mirror surface.

Clean the mirror using a soft, dry, non-abrasive cloth.

Restore power at the breaker and operate the mirror via the wall switch.

WC-LEDALM7036  
Installation Guide